

# Submittal Data Sheet

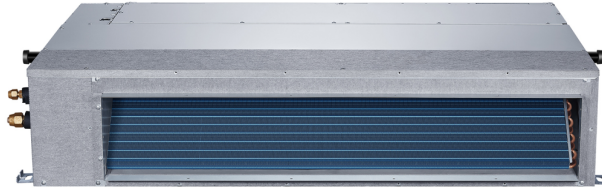

Project Name:		Approval:	
Location:		Date:	
Engineer:		Construction:	
Submitted to:		Unit #:	
Submitted by:		Drawing #:	
Reference:			

Code	
Indoor unit code	453077629
Outdoor unit code	453076296
Model	
Indoor unit model	BM12MCD
Outdoor unit model	BMHH12Y23C



### PERFORMANCE DATA

Power supply	Ph-V-Hz	208-230V,1Ph,60Hz
--------------	---------	-------------------

#### Cooling

Capacity	Btu/h	12000
Input	W	960
Rated current	A	4.4
EER	Btu/w	12.5
SEER	Btu/w	20.5

#### Heating at 47

Capacity	Btu/h	12000
Input	W	1065
Rated current	A	4.88
COP	W/W	3.3
HSPF4		11
HSPF5		9.5

#### Electrical

MINIMUM CIRCUIT AMPACITY	A	9
MAX. FUSE	A	15
Connection wiring		16*4 AWG

#### Compressor

Model		ATM115D43UFZ2
Type		ROTARY
Brand		GMCC
Capacity	Btu/h	11430
Input	W	870
Rated current(RLA)	A	5.65
Locked rotor Amp(LRA)	A	---
Thermal protector		---
Thermal protector position		---
Refrigerant oil/oil charge	ml	ESTER OIL VG74 / 500

#### SYSTEM DATA

Design pressure	PSIG	550/340 PSIG
Refrigerant type	oz	R410A/52.9
Refrigerant precharge	ft	25
Additional charge per ft.	oz	0.16
Liquid side/ Gas side	mm(in)	Φ6.35/Φ12.7(1/4"/1/2")
Max. refrigerant pipe length	ft	82
Max. difference in level	ft.	33

#### ESP

ESP range	In. wg.	0-0.16
-----------	---------	--------

### INDOOR UNIT DATA

<b>Indoor fan motor</b>		
Model		ZKFN-55-8-22
Type		DC
Input		115
RLA	A	1.11
LRA	A	---
Winding Resistance	Ω	---
Capacitor	uF	---
Speed(Hi/Mi/Lo)	r/min	1170/1030/850

#### Air flow & Noise level

Indoor air flow (Hi/Lo)	CFM	353/283/177
Indoor noise level (Hi/Lo)	dB(A)	38/36/33.5

#### Indoor unit

Dimension(W*D*H)	inch	27.56x17.72x7.87
Packing (W*D*H)	inch	33.86x21.26x10.83
Net/Gross weight	lbs.	37.5/48.3

### OUTDOOR UNIT DATA

<b>Outdoor fan motor</b>		
Model		ZKFN-40-8-1L
Type		DC
Input		63
RLA	A	0.38
LRA	A	---
Winding Resistance	Ω	---
Capacitor	uF	---
Speed	r/min	810

#### Air flow & Noise level

Outdoor air flow	CFM	1180
Outdoor noise level	dB(A)	57

#### Outdoor unit

Dimension(W*D*H)	inch	31.5x13.11x21.81
Packing (W*D*H)	inch	36.22x15.35x24.21
Net/Gross weight	lbs.	88.18/93.7

#### Operation temperature

Indoor(cooling/ heating)	Deg. F	62~90/32~86
Outdoor(cooling/heating)	Deg. F	-22~122/ -22~86
Application area	sq.ft	172-252

### INDOOR UNIT

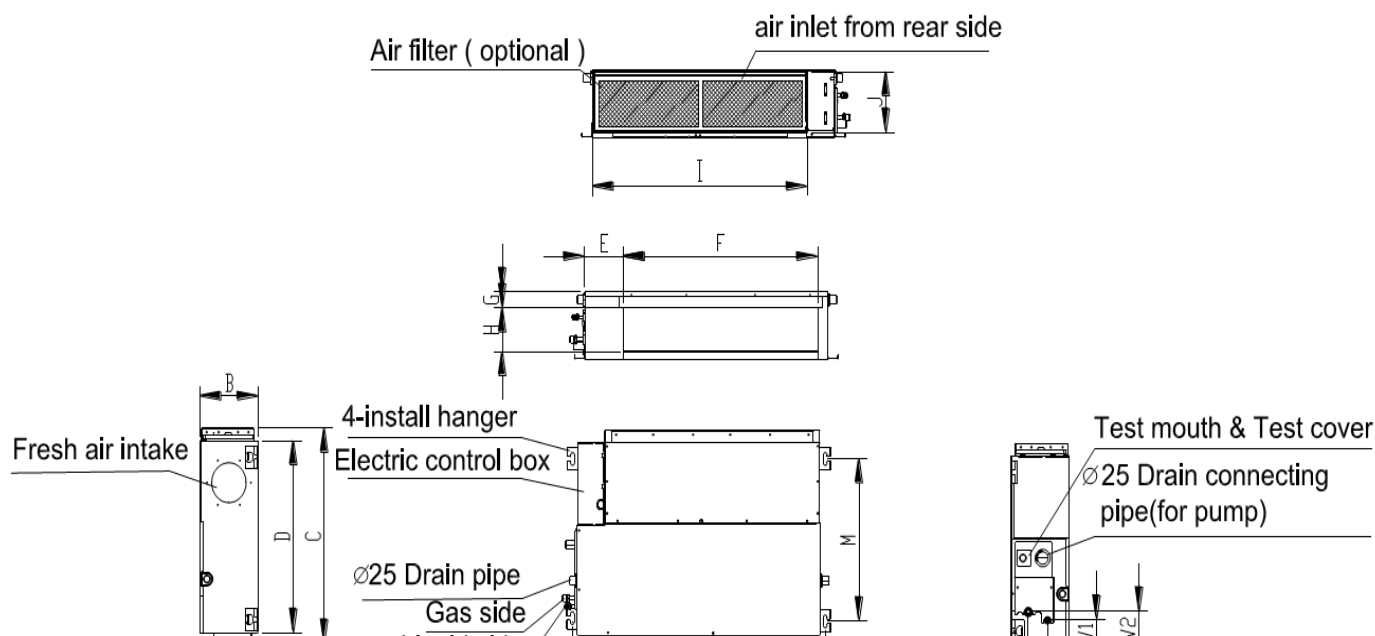

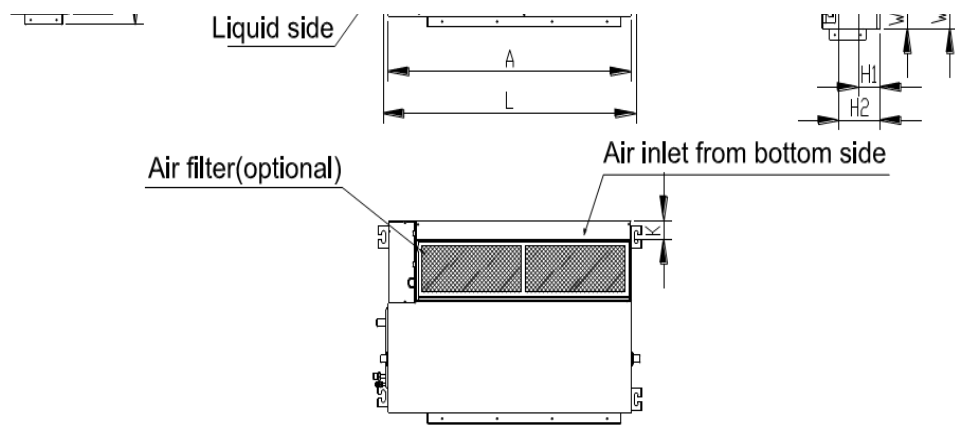

Capacity (Btu)	Outline dimension (mm)				Air outlet opening size				Air return opening size			Size of mounted plug		Size of gas and liquid valve			
	A	B	C	D	E	F	G	H	I	J	K	L	M	H1	H2	W1	W2
12000	700	200	506	450	137	537	30	152	599	186	50	741	360	84	140	84	84

**OUTDOOR UNIT**

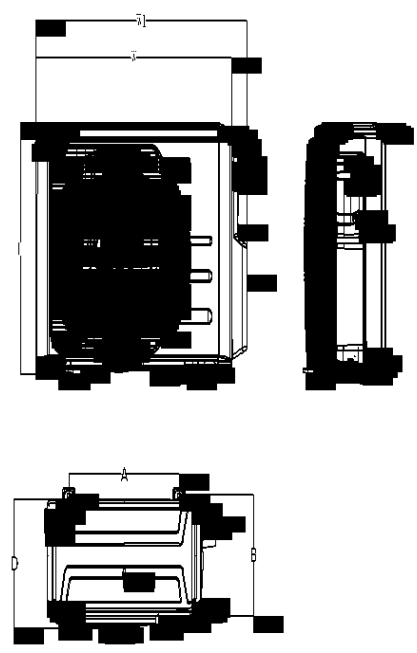

Model	W (inch)	D (inch)	H (inch)	W1 (inch)	A (inch)	B (inch)
BMHH12Y23C	31.5	13.1	21.8	34.3	20.2	13.4

**MTIU-12HWFN1-M**

